

2301 Greenleaf Avenue, Elk Grove Village, IL - Unit 2



ML REALTY  
PARTNERS



# 35,170 SF AVAILABLE

## Building Specifications

Building Size:	±63,080 SF
Available:	±35,170 SF
Office:	±3,687 SF
Clear Height:	16' Clear
Loading:	2 Interior Docks
Drive in Doors :	1
Electric:	4,000 Amps @ 480 Volts
Car Parking:	47 Stalls
Sprinkler System:	Yes

## Building Features

- › One mile to I-90 full interchange
- › Two miles to I-390
- › **Heavy power at 4,000 amps**
- › T-5 warehouse lighting
- › Warehouse washrooms and locker room
- › **Multiple existing bus ducts**
- › Public transportation at Greenleaf Avenue and Elmhurst Road
- › Ability to secure lot

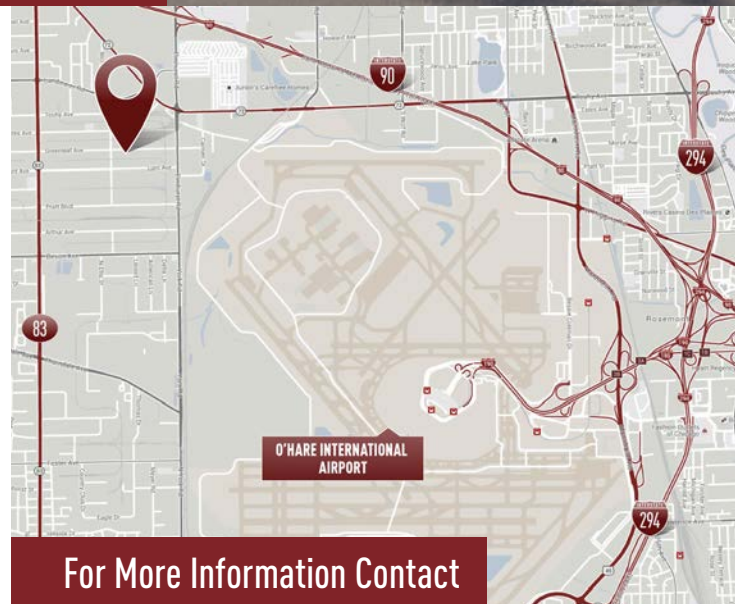

For More Information Contact



**RICHARD DALY**  
630-782-9520 ext 3859  
rdaly@darwinrealty.com

**JEFFREY PROVENZA**  
630-782-9520 ext 3858  
jprovenza@darwinrealty.com

**CHRIS MERGENTHALER**  
630-782-9520 ext 3862  
cmergenthaler@darwinrealty.com

Owner:  
ML Realty Partners \ \ One Pierce Place, Suite 450, Itasca, Illinois 60143 \ \ 630-250-2900  
Information contained herein is subject to change and verification, and no liability for errors or omissions is assumed. © 2020 All Rights Reserved. ML Realty Partners

# 2301 Greenleaf Avenue, Elk Grove Village, IL - Unit 2

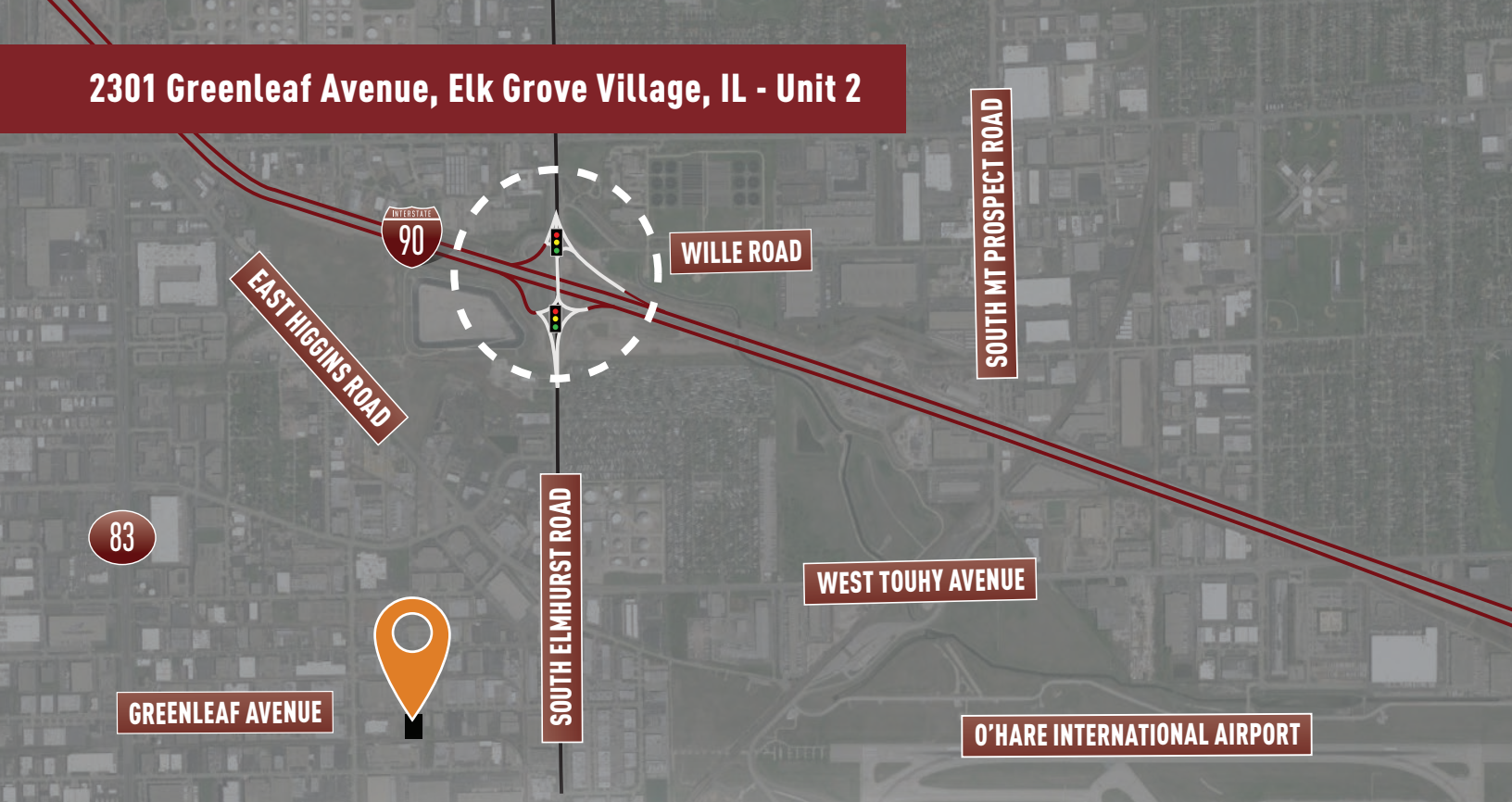

## Master Plan Rendering

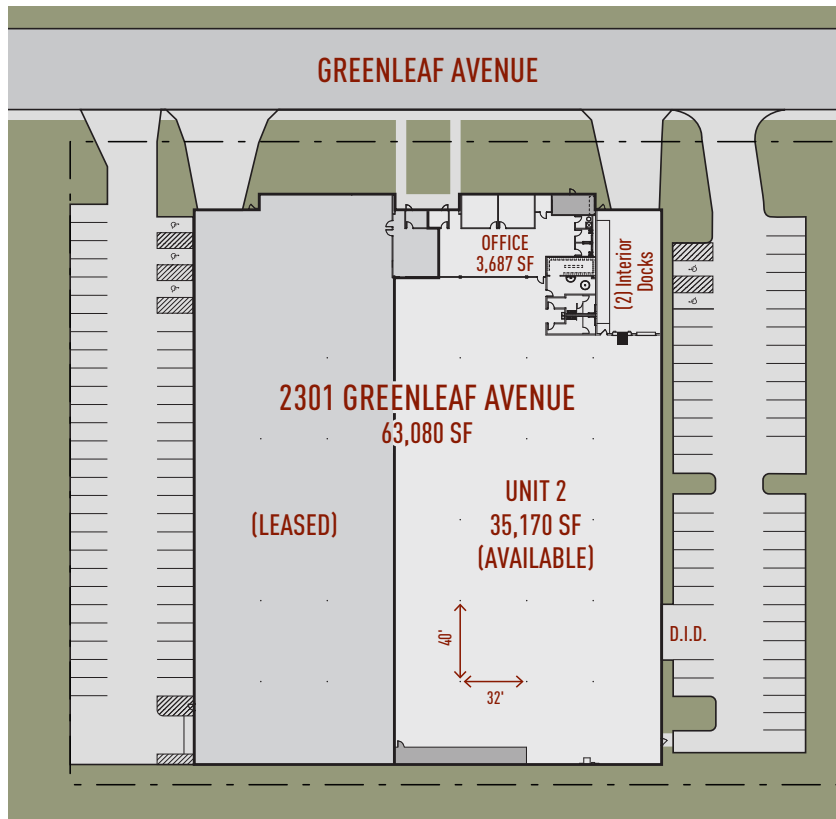

**ML REALTY**  
PARTNERS

ML Realty Partners \ One Pierce Place, Suite 450, Itasca, Illinois 60143 \ 630-250-2900

Information contained herein is subject to change and verification, and no liability for errors or omissions is assumed. © 2020 All Rights Reserved. ML Realty Partners