

1125 N. Union Bower Road, Irving, TX - Suite 150



ML REALTY
PARTNERS



20,650 SF AVAILABLE

Building Specifications

Building Size:	30,970 SF
Total Available:	20,650 SF
Office:	1,600 SF
Clear Height:	22' Clear
Loading:	6 Dock High Doors
Electric:	400 Amps, 208/240 Volts, 3-Phase
Car Parking:	Ample
Column Spacing:	41' x40'
Sprinkler System:	Yes

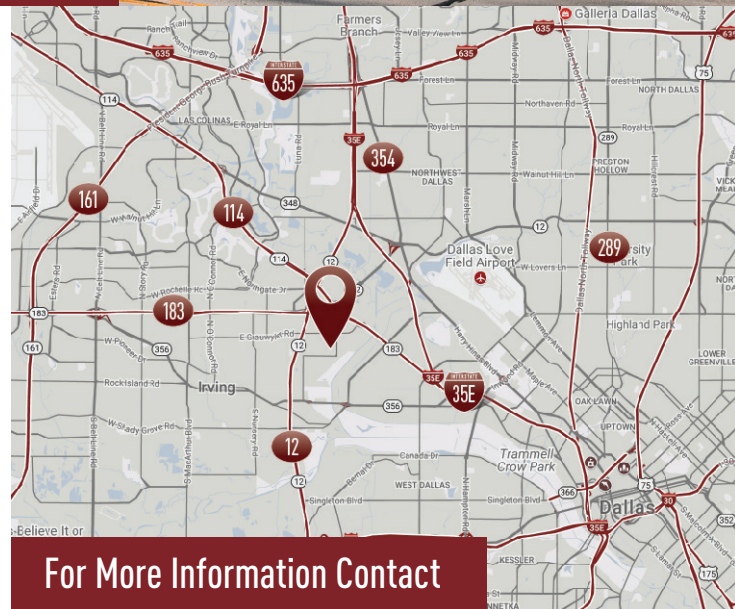

For More Information Contact



CANON SHOULTS
972-280-8328
cshoultshldallas.com

ANDREW GILBERT
972-280-8312
agilbert@hldallas.com

Building Features

- › Strategically located in the South Stemmons Corridor offering first-class image and environment
- › Easy access to major thoroughfares
- › Professionally landscaped

Owner:
ML Realty Partners \ \ 8150 N Central Expy, Suite M-2030, Dallas, TX 75206 \ \ 214-389-1155
Information contained herein is subject to change and verification, and no liability for errors or omissions is assumed. © 2020 All Rights Reserved. ML Realty Partners

1125 N. Union Bower Road, Irving, TX - Suite 150



Master Plan Rendering

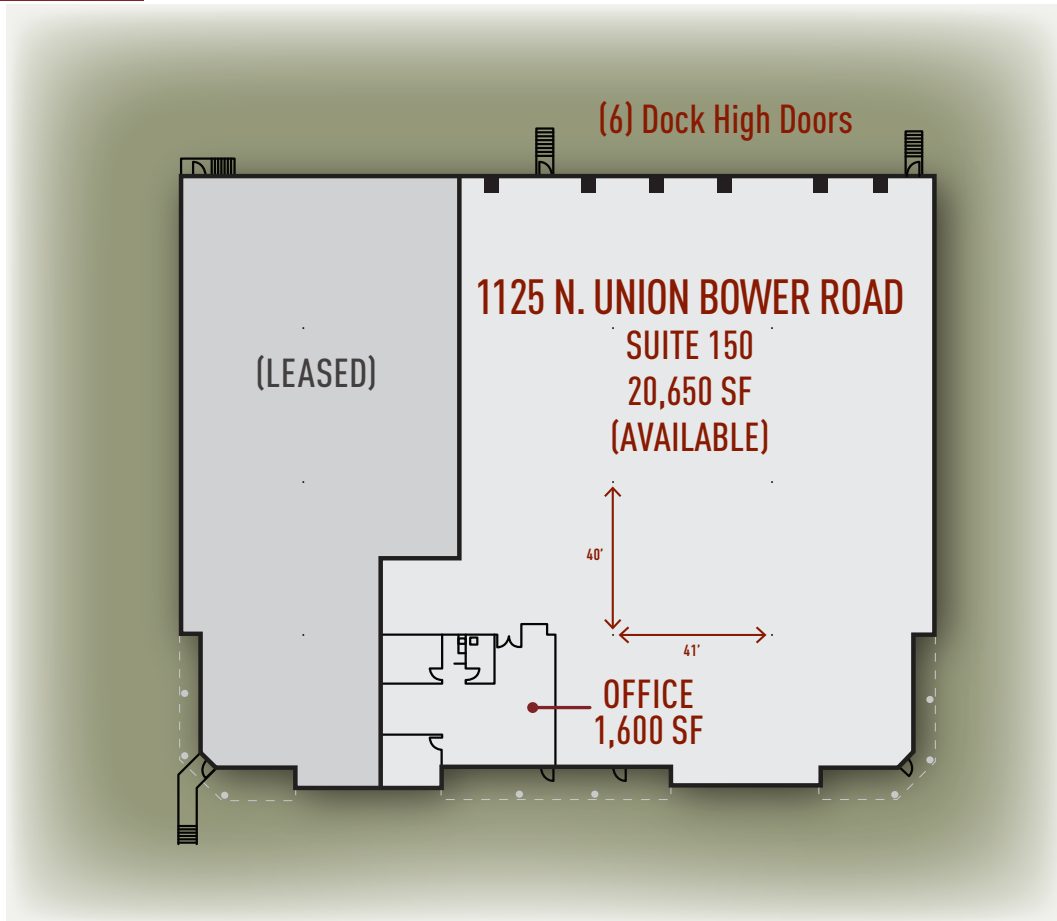

ML REALTY
PARTNERS

NORTH →