

1125 N. Union Bower Road, Irving, TX - Suite 150



ML REALTY
PARTNERS



20,650 SF AVAILABLE

Building

| | |
|-------------------|----------------------------------|
| Building Size: | 30,970 SF |
| Total Available: | 20,650 SF |
| Office: | 1,600 SF |
| Clear Height: | 22' Clear |
| Loading: | 6 Dock High Doors |
| Electric: | 400 Amps, 208/240 Volts, 3-Phase |
| Car Parking: | Ample |
| Column Spacing: | 41' x 40' |
| Sprinkler System: | Yes |

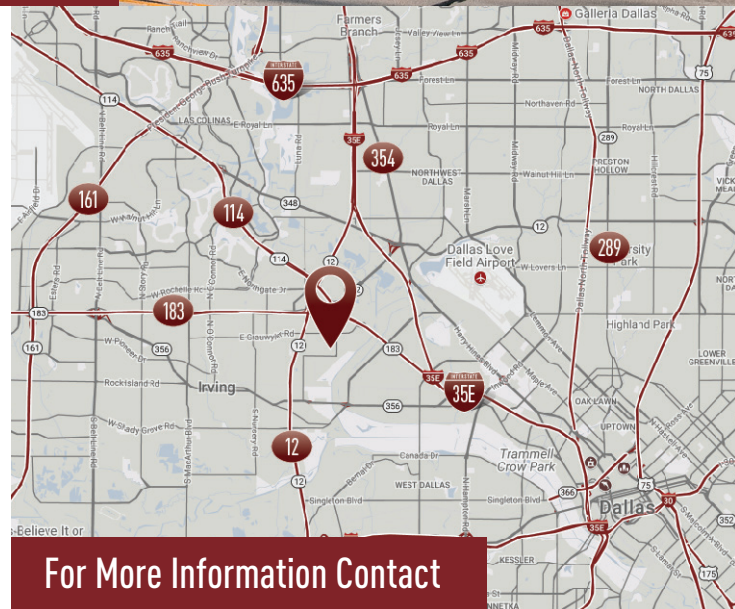

For More Information Contact



ANDREW GILBERT
972-280-8312
agilbert@hldallas.com

KEATON BRICE
972-421-1956
kbrice@hldallas.com

Building

- › Strategically located in the South Stemmons Corridor offering first-class image and environment
- › Easy access to I-35, TX-183, and Loop 12
- › Close proximity to Dallas Love Field Airport

Owner:
ML Realty Partners \ \ 8150 N Central Expy, Suite M-2030, Dallas, TX 75206 \ \ 214-389-1155
Information contained herein is subject to change and verification, and no liability for errors or omissions is assumed. © 2024 All Rights Reserved. ML Realty Partners

1125 N. Union Bower Road, Irving, TX - Suite 150



Master Plan Rendering

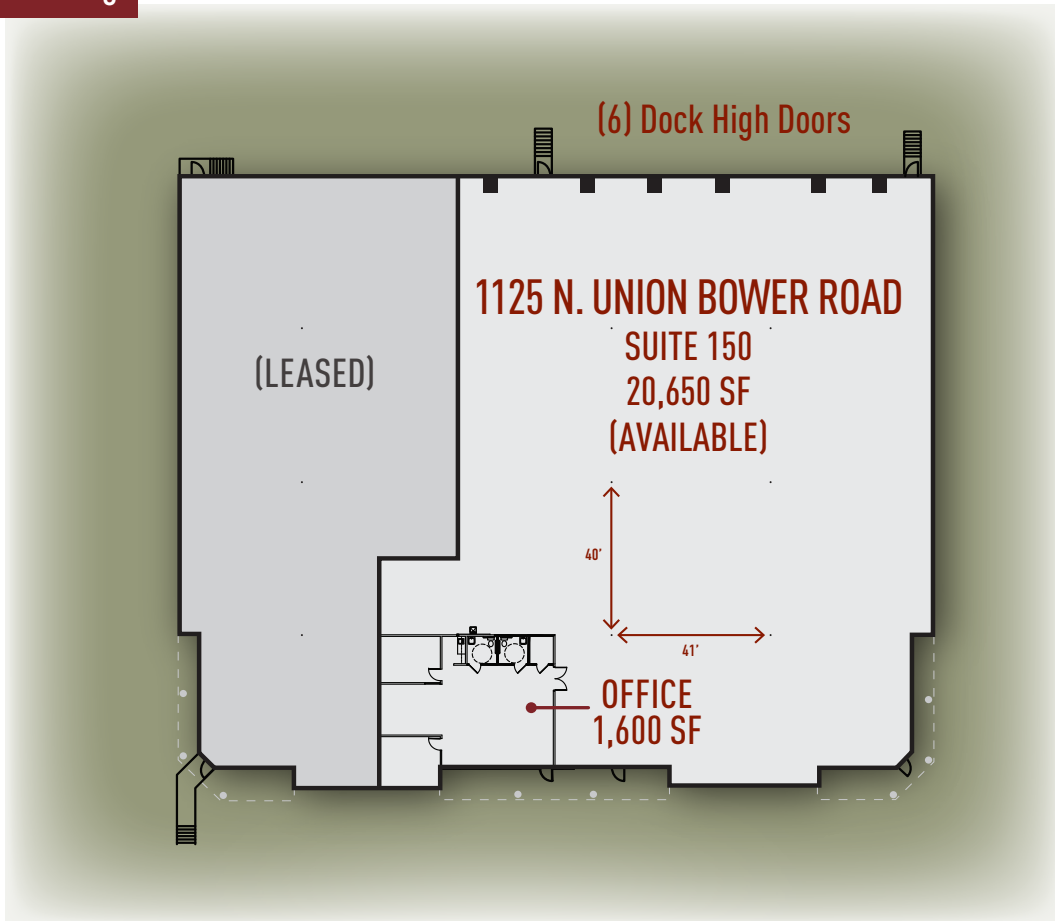

ML REALTY
PARTNERS

NORTH →