

400 Union Bower Court, Irving, TX - Suite 422



ML REALTY
PARTNERS



13,945 SF AVAILABLE

Building Specifications

Building Size:	58,540 SF
Total Available:	13,945 SF
Office:	995 SF
Clear Height:	19' Clear
Loading:	2 Dock High Door; 3 Grade Level Docks
Electric:	400 Amps, 208 Volts, 3-Phase
Car Parking:	Ample
Column Spacing:	32' x 37'
Sprinkler System:	Yes

Building Features

- › Strategically located in the South Stemmons Corridor offering first-class image and environment
- › Easy access to major thoroughfares
- › 9 miles northwest of Downtown Dallas

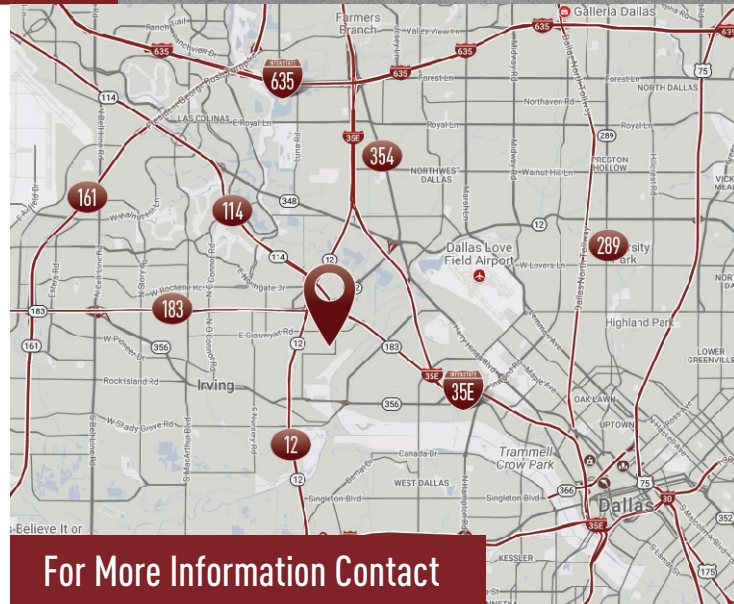

For More Information Contact



ANDREW GILBERT
972-280-8312
agilbert@holtlunsford.com

KEATON BRICE
972-983-7099
kbrice@holtlunsford.com

Owner:

ML Realty Partners \ 8150 N Central Expy, Suite M-2030, Dallas, TX 75206 \ 214-389-1155

Information contained herein is subject to change and verification, and no liability for errors or omissions is assumed. © 2021 All Rights Reserved. ML Realty Partners

400 Union Bower Court, Irving, TX - Suite 422



Master Plan Rendering

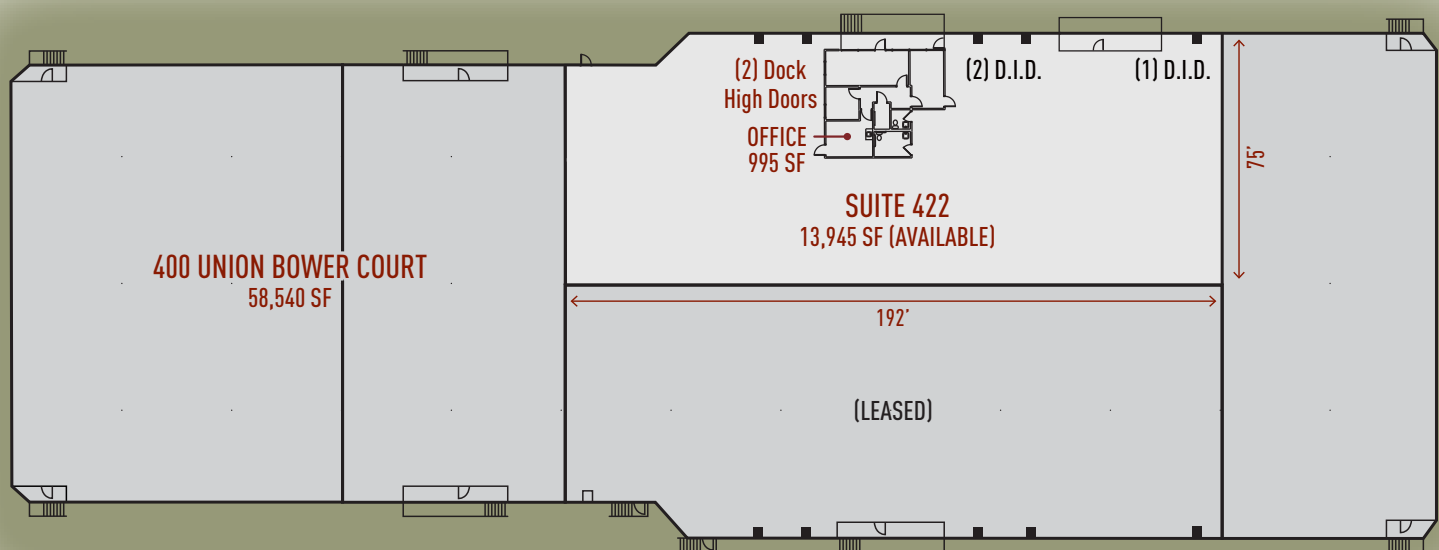

NORTH →



ML Realty Partners \ 8150 N Central Expy, Suite M-2030, Dallas, TX 75206 \ 214-389-1155

Information contained herein is subject to change and verification, and no liability for errors or omissions is assumed. © 2021 All Rights Reserved. ML Realty Partners