

133 South Rohlwing Road, Addison, IL



ML REALTY
PARTNERS

± 37,819 SF AVAILABLE

Building Specifications

Building Size:	109,728 SF
Available:	± 37,819 SF (1st Floor Only)
Office:	± 2,776 SF (1st Floor Only)
Clear Height:	19' - 27' Clear
Loading:	8 Exterior Truck Docks, 4 Interior Truck Docks, 6 Short Bay Interior Docks
Drive in Doors:	1
Electric:	400 Amps; 277/480 Volts
Sprinkler System:	Wet
Column Spacing:	50' x 30'
Lighting:	LED

Building Features

- › Immediate access to I-355 via Army Trail Road Interchange
- › **Secured outdoor storage/parking**
- › Building signage available
- › High visibility on Rohlwing Road
over 23,000 vehicles per day
- › Newly remodeled office
- › Full north/south access onto Rohlwing Road

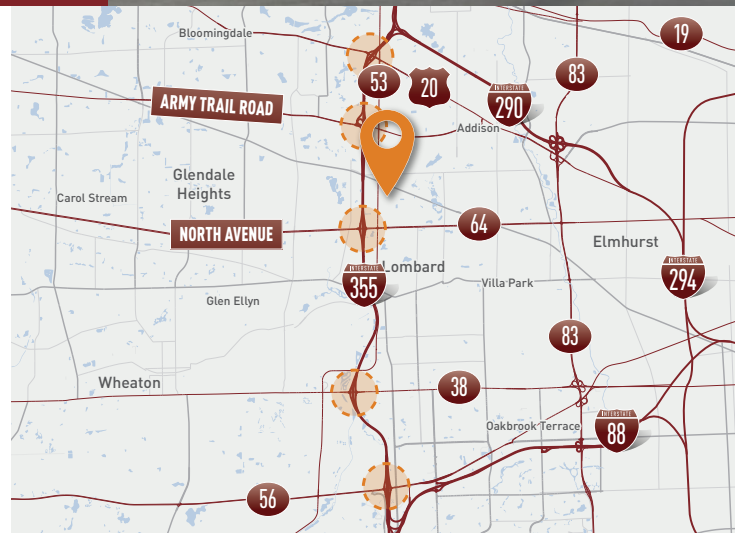

For More Information Contact

TRANSWESTERN®

JUSTIN LERNER, SIOR

847-588-5665

justin.lerner@transwestern.com

JOE KARMIN, SIOR

847-588-5670

joe.karmin@transwestern.com

ROSS LEHRMAN

847-588-5671

ross.lehrman@transwestern.com

Owner:

ML Realty Partners \\\ One Pierce Place, Suite 450, Itasca, Illinois 60143 \\\ 630-250-2900

Information contained herein is subject to change and verification, and no liability for errors or omissions is assumed. © 2021 All Rights Reserved. ML Realty Partners

133 South Rohlwing Road, Addison, IL

FULL 4-WAY
INTERCHANGE

- ±23,600
Vehicles Per Day
- Immediate
Access to 355

ROHLWING ROAD

ARMY TRAIL ROAD



Master Plan Rendering



ML REALTY
PARTNERS

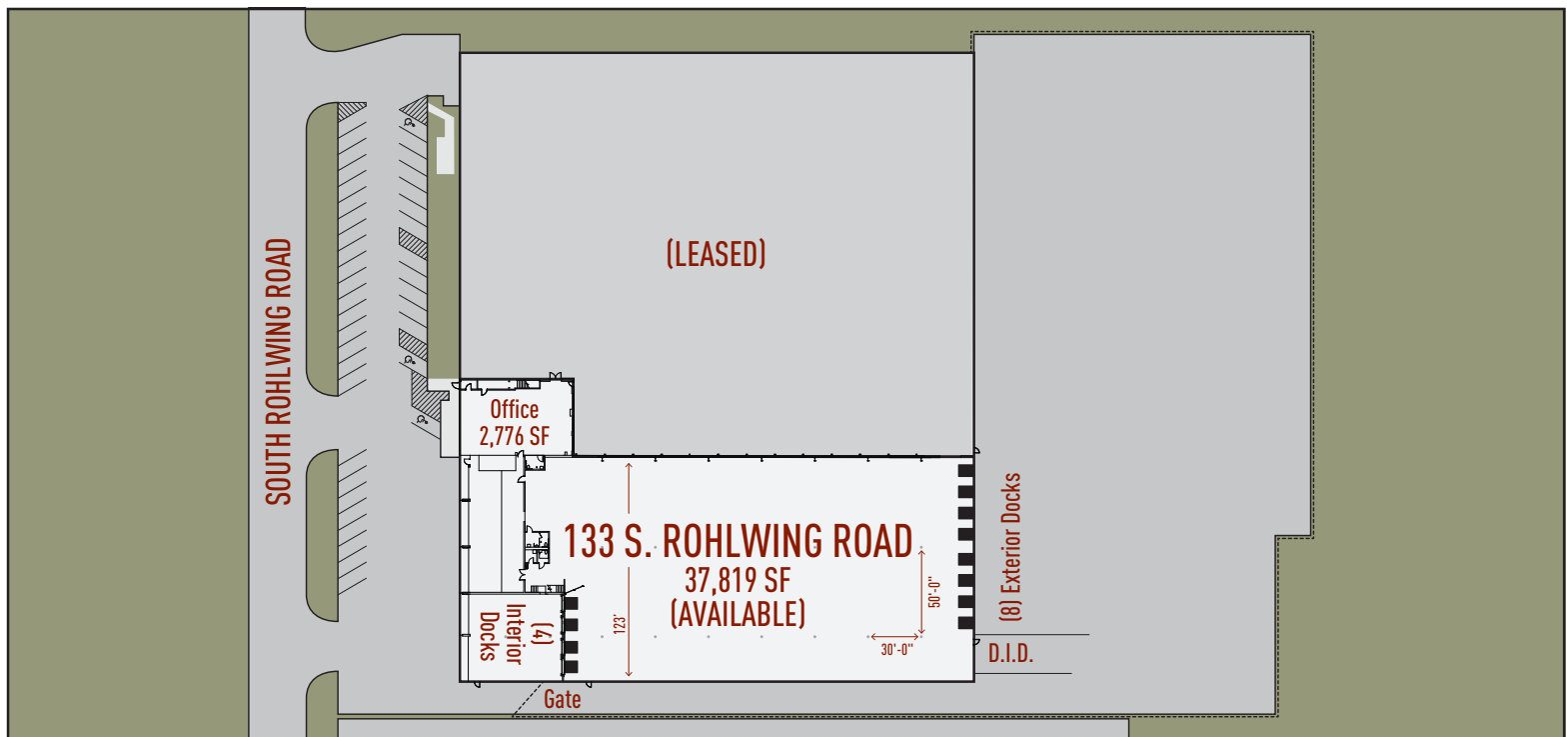

NORTH ↑