

1101 N. Union Bower Road, Irving, TX - Suite 140-160



ML REALTY
PARTNERS

20,200 SF AVAILABLE

Building Specifications

Building Size:	36,175 SF
Total Available:	20,200 SF
Office:	11,245 SF
Clear Height:	24' Clear
Loading:	6 Dock High Doors
Car Parking:	Ample
Sprinkler System:	Yes

Building Features

- › Strategically located in the South Stemmons Corridor
- › Easy access to Interstate 35E
- › Minutes from Loop 12 and Hwy 183
- › Within 25 minutes of DFW International Airport, Dallas Love Field and Dallas CBD

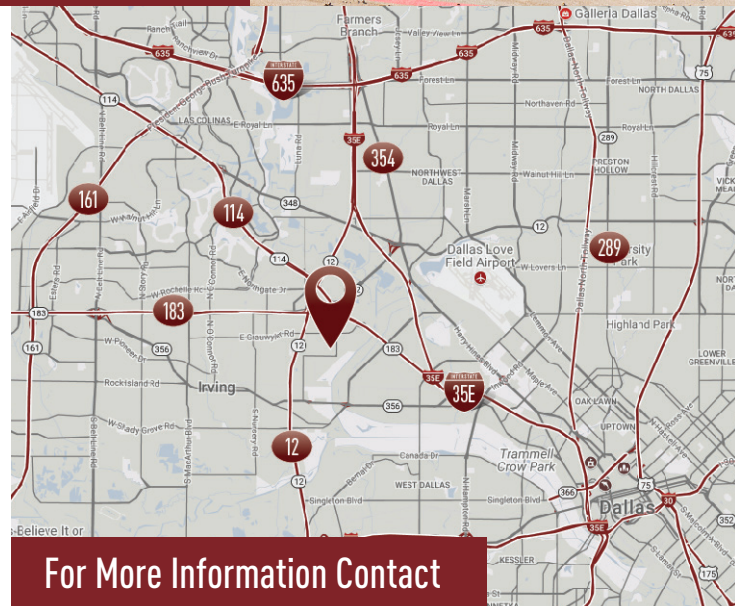

For More Information Contact



ANDREW GILBERT
972-280-8312
agilbert@holtlunsford.com

KEATON BRICE
972-421-1956
kbrice@holtlunsford.com

Owner:

ML Realty Partners \ 8150 N Central Expy, Suite M-2030, Dallas, TX 75206 \ 214-389-1155

Information contained herein is subject to change and verification, and no liability for errors or omissions is assumed. © 2021 All Rights Reserved. ML Realty Partners

1101 N. Union Bower Road, Irving, TX - Suite 140-160



Master Plan Rendering

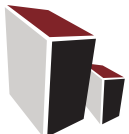
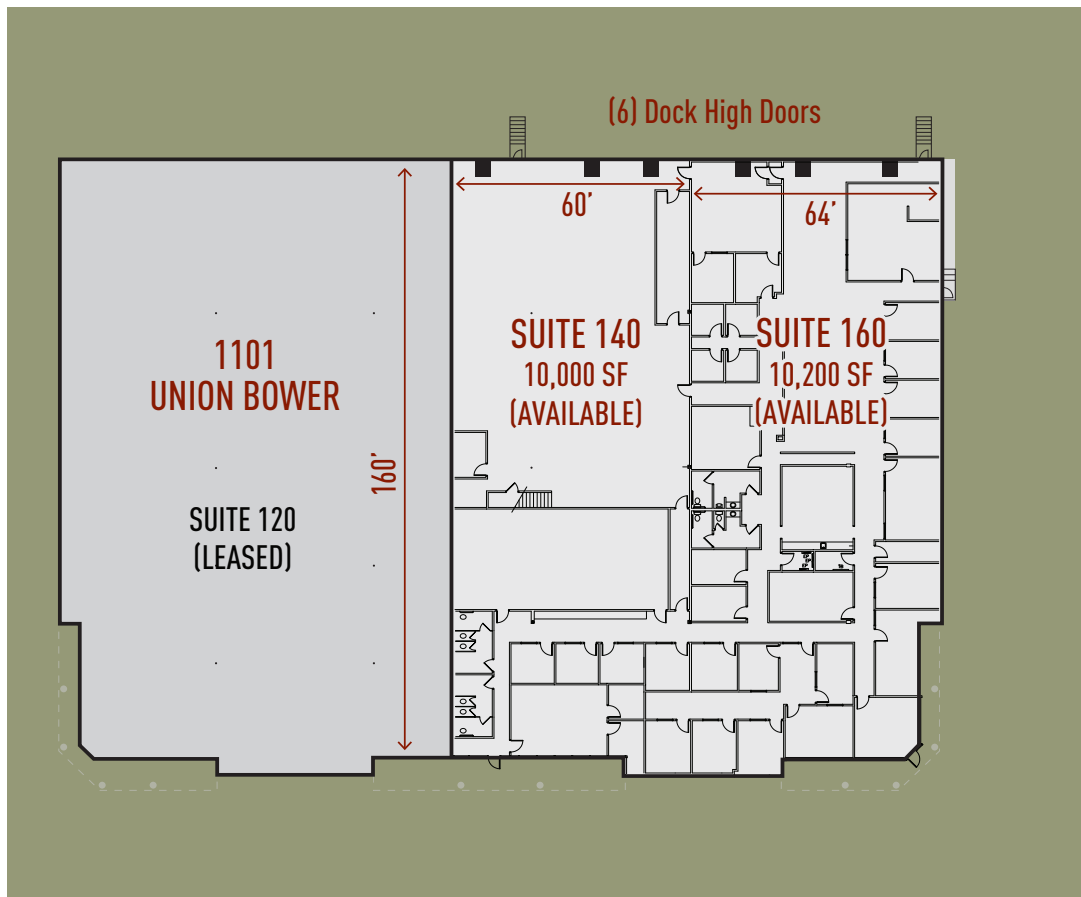

ML REALTY
PARTNERS

NORTH →

ML Realty Partners \ 8150 N Central Expy, Suite M-2030, Dallas, TX 75206 \ 214-389-1155

Information contained herein is subject to change and verification, and no liability for errors or omissions is assumed. © 2021 All Rights Reserved. ML Realty Partners