

400 Union Bower Court, Irving, TX - Suite 416



ML REALTY
PARTNERS



9,600 SF AVAILABLE

Building Specifications

Building Size:	58,540 SF
Total Available:	9,600 SF
Office:	2,354 SF
Clear Height:	19' Clear
Loading:	1 Dock High Door; 2 Grade Level Docks
Car Parking:	Ample
Column Spacing:	32' x 37'
Sprinkler System:	Yes

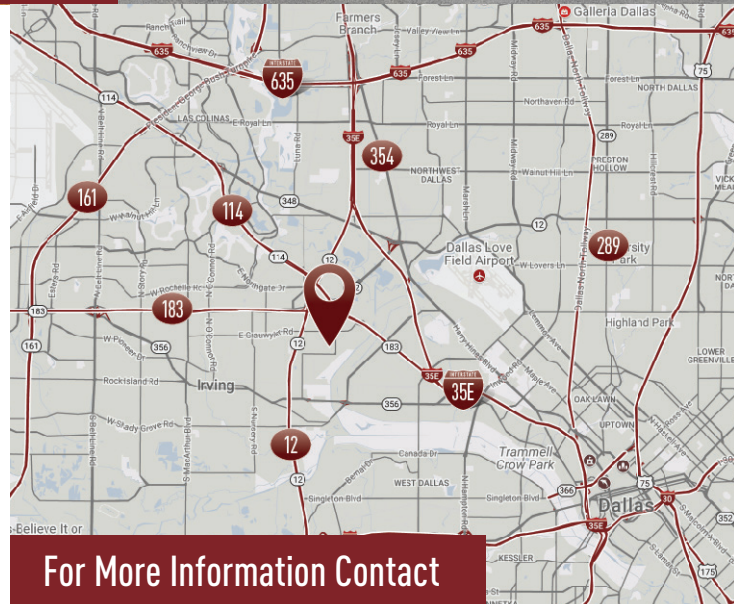

For More Information Contact

Building Features

- › Strategically located in the South Stemmons Corridor
- › Easy access to Interstate 35E
- › Minutes from Loop 12 and Hwy 183
- › Within 25 minutes of DFW International Airport, Dallas Love Field and Dallas CBD



ANDREW GILBERT
972-280-8312
agilbert@holtlunsford.com

KEATON BRICE
972-421-1956
kbrice@holtlunsford.com

Owner:

ML Realty Partners \ 8150 N Central Expy, Suite M-2030, Dallas, TX 75206 \ 214-389-1155

Information contained herein is subject to change and verification, and no liability for errors or omissions is assumed. © 2022 All Rights Reserved. ML Realty Partners

400 Union Bower Court, Irving, TX - Suite 416



Master Plan Rendering

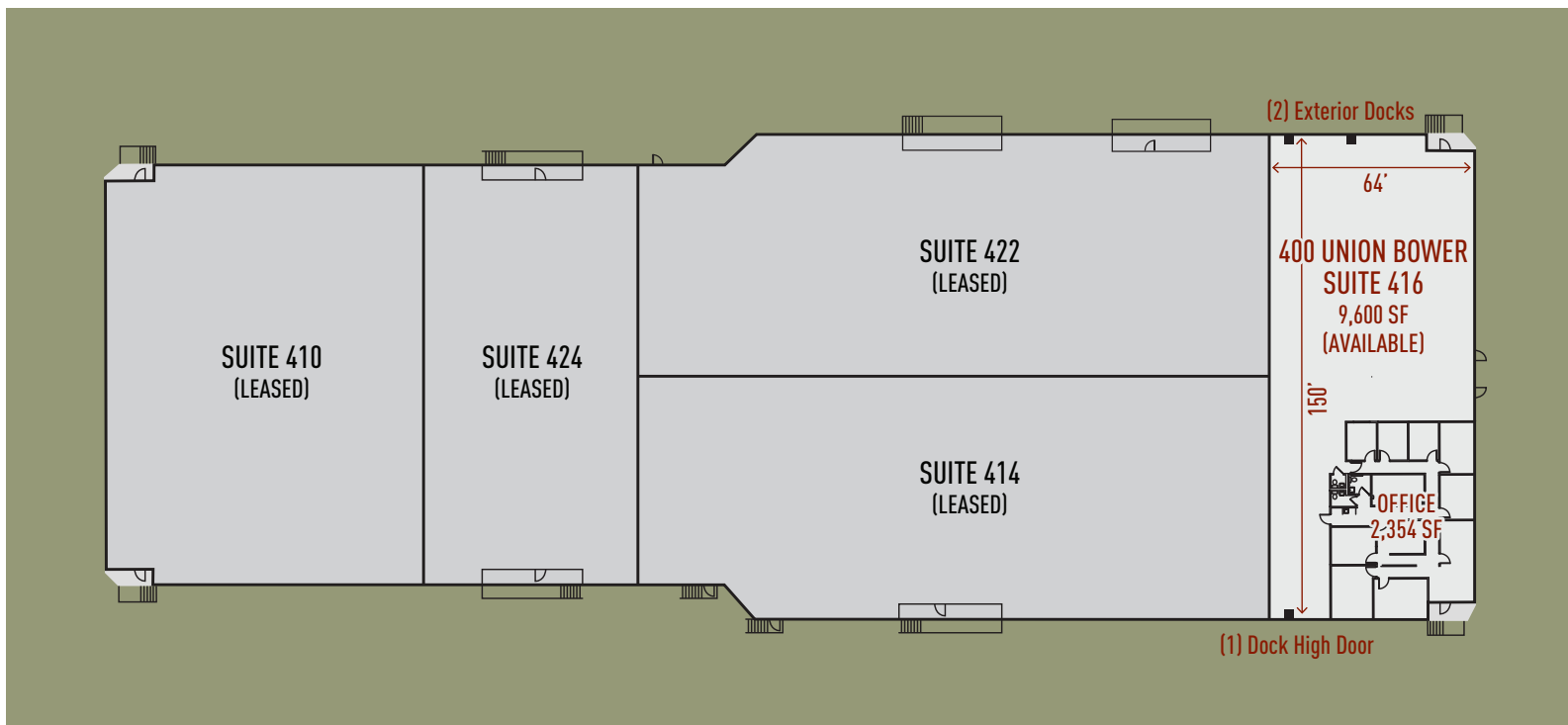

NORTH →



ML Realty Partners \ 8150 N Central Expy, Suite M-2030, Dallas, TX 75206 \ 214-389-1155

Information contained herein is subject to change and verification, and no liability for errors or omissions is assumed. © 2022 All Rights Reserved. ML Realty Partners