

835 Lively Boulevard, Wood Dale, IL



ML REALTY
PARTNERS

DUPAGE COUNTY TAXES

20,000 SF AVAILABLE

Building Specifications

Building Size:	65,642 SF
Available:	20,000 SF
Office:	2,264 SF
Clear Height:	21' Clear
Loading:	4 Interior Docks
Drive-in Doors:	2
Lighting:	LED
Sprinklers:	Wet
Power:	200 Amps 277/480 Volts, 3-Phase

Building Features

- › Located in O'Hare submarket with **DuPage County taxes**
- › Close proximity to O'Hare
- › Outside area
- › Warehouse drive-through access



For More Information Contact

NAI Hiffman
Commercial Real Estate Services, Worldwide.

HIFFMAN
NATIONAL

PADDY DWYER
630-317-0794
pdwyer@hiffman.com

JOE BRONSON
630-317-0725
jbronson@hiffman.com

Owner:
ML Realty Partners \ \ One Pierce Place, Suite 450, Itasca, Illinois 60143 \ \ 630-250-2900
Information contained herein is subject to change and verification, and no liability for errors or omissions is assumed. © 2025 All Rights Reserved. ML Realty Partners

7300 Linder Avenue, Skokie, IL



Master Plan Rendering

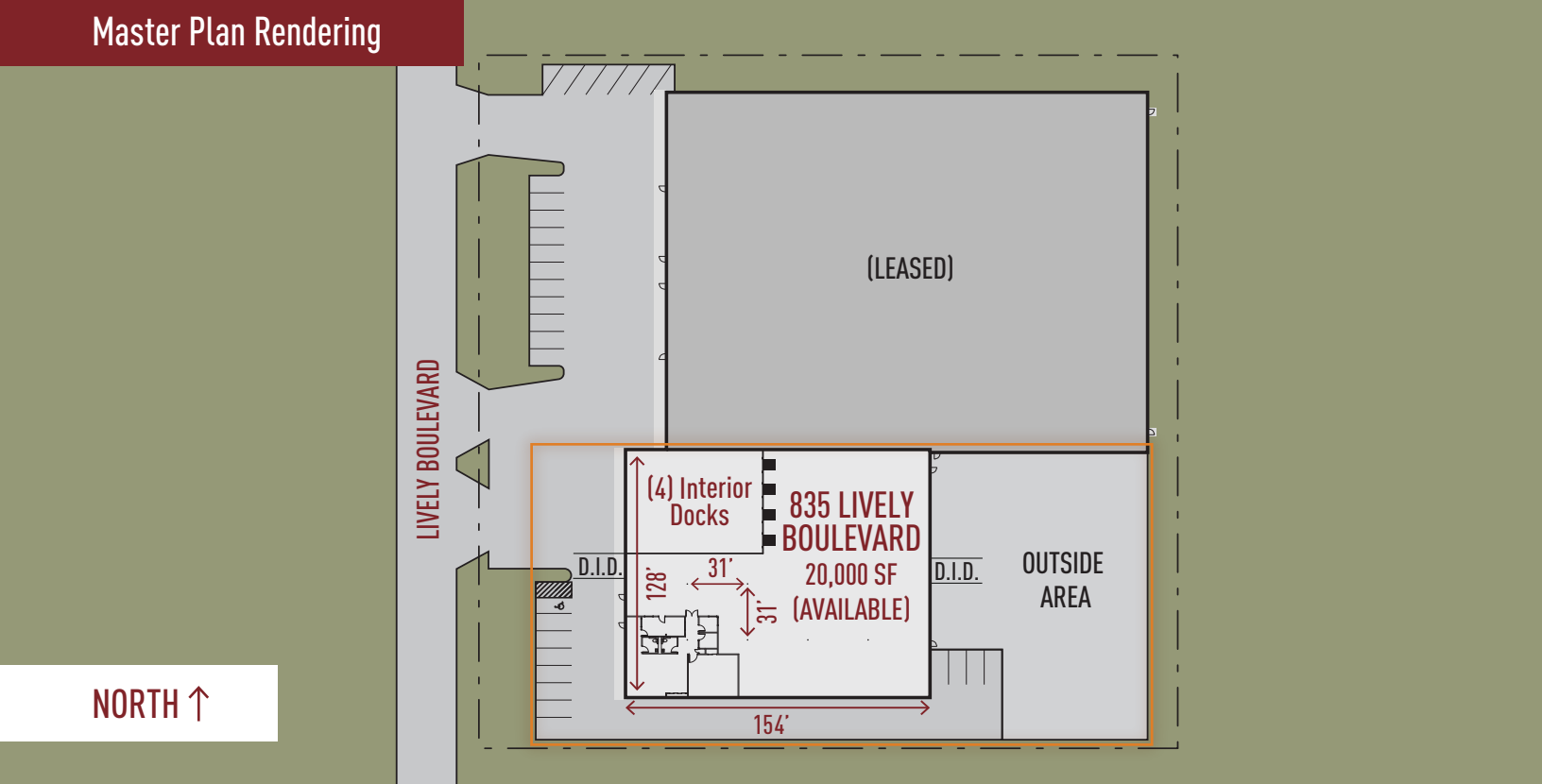

ML Realty Partners \ \ One Pierce Place, Suite 450, Itasca, Illinois 60143 \ \ 630-250-2900

Information contained herein is subject to change and verification, and no liability for errors or omissions is assumed. © 2025 All Rights Reserved. ML Realty Partners